

We provide a Japanese cultural experience for anyone, regardless of their age, ability or language.

【Washinkan offers ...】

- A wide range of programs for Japanese cultural experiences such as Tea ceremony, Flower arrangement, Calligraphy, Kitsuke etc.
 - Wheelchair friendly Japanese cooking classes.
 - Martial arts programs such as Kendo, and Aikido.
- *Groups may split up and simultaneously engage in different activities, offering a unique experience to each participant.

Morning Tea ceremony @ YOUKOU-AN

9:30 - 10:15
10:30 - 11:15

Reservations are not required.

* We may request that you choose an alternative date based on space availability.

11:30 - 12:15

Reservation are required between
9:00-11:00 AM. Tel : 075-533-6500

【Facilities and Service】

- The building entrance is handicap accessible.
- The entrance to Tea room and Multipurpose hall is disabled friendly.
- A large Japanese room and three smaller Japanese rooms separated by sliding doors are located on the 2nd floor.
- The building is equipped with 5 public restrooms, including one handicap accessible restroom.
- A chair lift for the elderly and the disabled is available.
- Full-time support from English speaking staff and certified care provider.
- Groups of up to 30 members are permitted.
- Located in a historical and intellectual area housing Sanjusangen-do Temple, Houkoku Shrine and National Museum.
- Guests may board and exit the bus at the front entrance.



For tea ceremony & origami.
Capacity: 30 people.

For tea ceremony & kitsuke.
Capacity: 10 people.

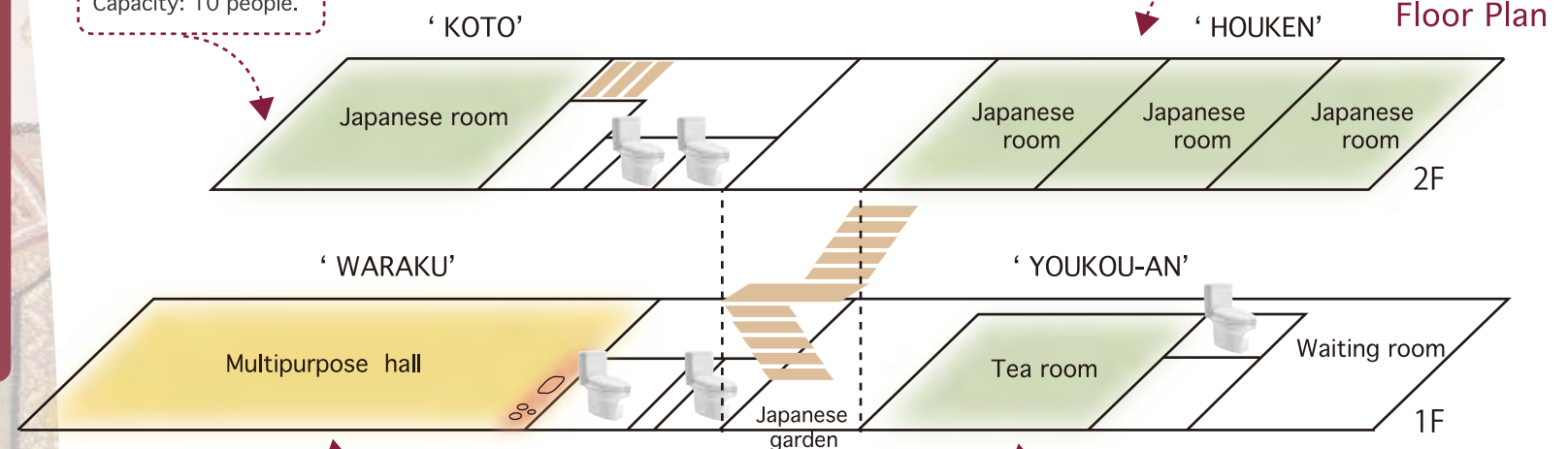

For flower arrangement, calligraphy & cooking.
Capacity: 16~20 people.
For martial arts.
Capacity: 3 people.

For tea ceremony.
Authentic tea room with Japanese garden & nijiriguchi entrance.
Capacity: 7 people.

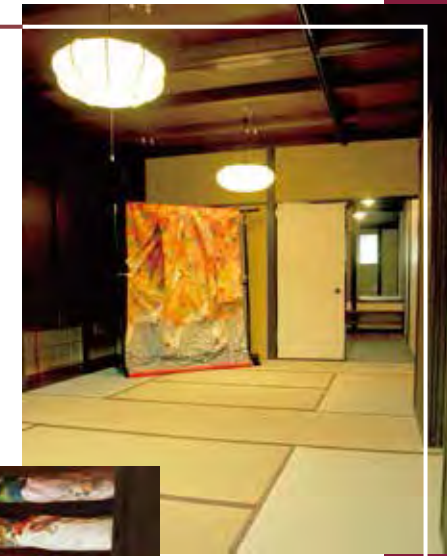

Floor Plan

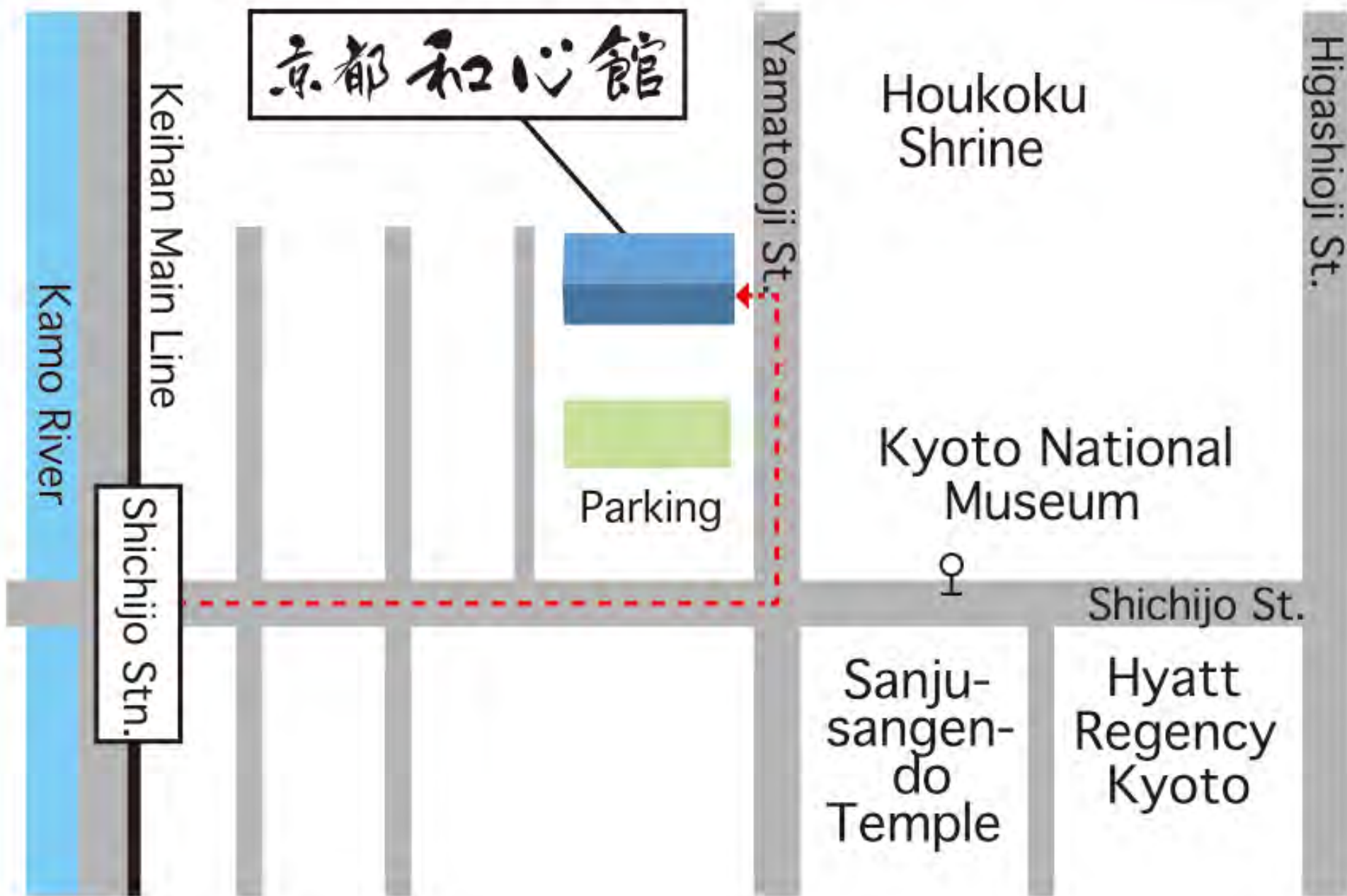

* Access *

- 5 min walk to the east from Keihan Shichijo Stn.
- Take Kyoto City Bus No.100, 206 or 208 from Kyoto Stn. and get off at Hakubutukan Sanjusangendo mae.